

MAUNAWAI
my Water



MAUNAWAI® PI PRIME®

Water Filter System with Filter cartridge **K2**

Assembly and Operating Instructions



www.maunawai.com

TABLE OF CONTENTS

Parts supplied	3
Water for life	4
Preparation	6
Assembly instructions	8
Care	10
When you are away	10
Changing the filters	11
Capacity of the components	12
Filtration time	12
Warranty	12
Liability	12
Troubleshooting	13
Contact	15
Table of replacement intervals	16

PARTS SUPPLIED

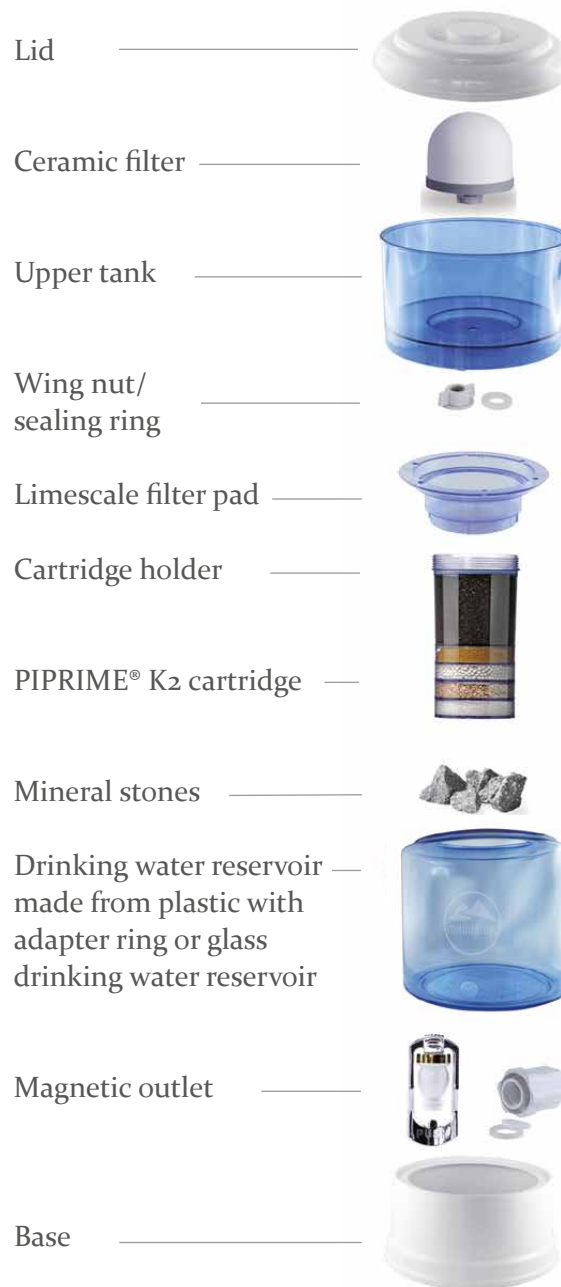

Important:
Before you begin
to put together your
MAUNAWAI® spring,
check that all of the
components illustrated
are present.

Origin and
Effectiveness



Ceramic filter

High-tech activated
carbon filter
made of coconut shells

Water for Live!

The Hawaiian word “Maunawai” means “mountain water” which is exactly what MAUNAWAI® filter systems do: they turn your tap water into mountain spring water.

This technology, developed 60 years ago in Japan, intended to make tap water into premium drinking water, guided by the way hot water springs work and life itself. By applying the five principles – **filtration, information, optimization, harmonization and biological availability** – the water is not only purified from undesirable elements, but also restructured and it regains its original cluster form.

After its long journey through urban water pipes, the water can now seep through the multi-layered MAUNAWAI® filter system – just as it does in Nature – without needing any pressure or electricity.

The most important filtration steps of MAUNAWAI® springs are:

The ceramic filter is the first step in filtering residues out of your water pipeline. It filters dust, rust, discolouration, suspended solids and smell out of the tap water. Due to its size of **0.2 µm**, bacteria cannot leak through.

Quality and performance of an activated carbon filter are determined by the filter material’s contaminant holding capacity and flow rate. In contrast to regular activated carbon filters, MAUNAWAI® filters have a considerably lower flow rate which, on the other hand, supports the contaminant holding

capacity of the granulate material. **The high-tech activated carbon made of coconut shells** removes pollutants such as chlorine and pesticides, heavy metals, drug and hormone residues as well as many other contaminants. MAUNAWAI® filters have also proven to be beneficial when it comes to substances otherwise difficult to remove by filtration such as copper, zinc and pharmaceuticals.

In the core of the MAUNAWAI® filter there are 20 different forms of ceramics, each accurately synchronised and dosed. In a special and elaborate process a porous but nevertheless mechanically stable ceramic matrix is designed. Natural information and characteristics are burnt into clay at 1,000 degrees Celsius, which trigger ion exchange and long-wave infrared radiation in the water thereby deleting unfitting, i.e. unnatural, information and restoring the molecular structure of the water (cluster).

This natural filtration and seepage process (without pipeline pressure) gives MAUNAWAI® spring water its **pleasant, soft and digestible taste**.

Enjoy your MAUNAWAI® water filter system!



Combination of
ceramic beads

PREPARATION

Before you begin assembly, please ensure that you carry out the following preparatory steps:

Remove all packaging from the system and from the individual filters.

Remove all packaging from the system and from the individual filters. Immerse all of the filter modules (ceramic filter, PIPRIME® filter cartridge, limescale filter pad) in tap water for at least 1 hour, better overnight, (see illustration on the right).

Important:
The ceramic balls in the FILTER CARTRIDGE contain a large amount of air. Soak them well and shake them several times.



Ceramic filter

PIPRI[®]
Filter cartridge

Place the CERAMIC FILTER with the filter screw uppermost in tap water (with no detergent) and hold it submerged for at least 1 hour, until all the air has escaped. The air can escape through the opening in the base.

Immerse the PIPRI[®] FILTER CARTRIDGE in tap water (without detergent) for 1 hour, better overnight, and shake it vigorously several times until the air has escaped.

Boil the mineral stones in salt water and rinse them with cold water afterwards. Clean the remaining parts (except the filters) with an organic detergent and rinse them with water as well.

Never use detergents on the filter modules! Do not use hot water, do not put parts in the dishwasher! Only use soft cleaning cloths to avoid scratches!

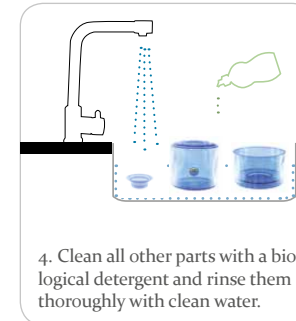
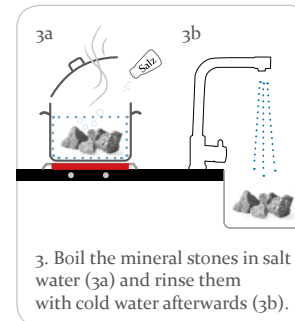
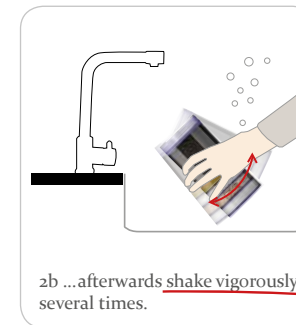
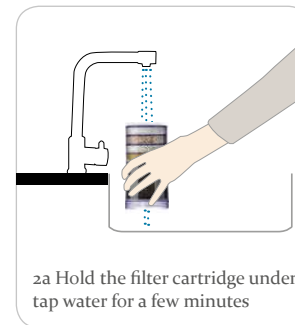
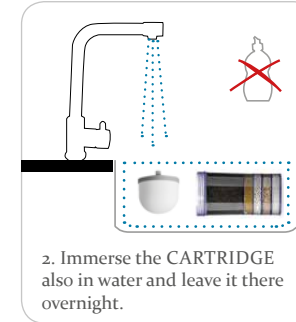
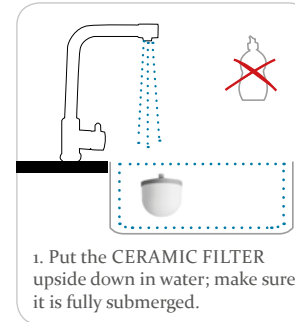

ASSEMBLY

Once you have completed the preparations, simply assemble your water filter system by completing the following steps:



1. WATER TAP:
fit to the reservoir with two seals (dry) one on the inside and one on the outside



2. DRINKING WATER RESERVOIR: place on the base



3. MINERAL STONES:
put in Drinking Water reservoir

1. Assemble the WATER TAP. The two sealing rings are attached to the drinking water reservoir, with one on the inside and one on the outside. The drinking water container should be dry around the silicone seal to prevent leaks occurring at a later date!

2. Place the DRINKING WATER RESERVOIR on the BASE.

3. Put 5-6 mineral stones at the bottom of the reservoir.

4./5. Screw the PIPRIME® FILTER CARTRIDGE into the CARTRIDGE HOLDER and suspend the filter unit in the drinking water reservoir.

6.-8. Then insert the CERAMIC FILTER into the opening provided in the UPPER TANK. Push the sealing ring on to the filter screw on the underside of the tank. Screw the filter into place using the wing nut.

9. Place the UPPER TANK on the drinking water reservoir.

10. The LID seals the upper tank.

Now fill with tap water and allow it to run through twice. Discard the water that comes through the first time or use it to water the garden.



4. FILTER CARTRIDGE:
screw to the CARTRIDGE HOLDER



5. FILTER CARTRIDGE:
suspend in the glass reservoir



6. CERAMIC FILTER: insert into the upper tank from inside



7. SEALING RING:
push onto the filter screw on the underside of the tank



8. Wing nut: screw tightly on to the filter screw



9. UPPER TANK: put in place



10. LID: put in place



Fill with tap water and let it run through completely twice.

Important:
Only filter water under supervision. If you fill the system with too much water (max. 8 litres), it can overflow through the drinking water reservoir.

Important:
Only use drinking water or tap water that is suitable and approved for human consumption.

Now your MAUNAWAI® water system is ready to use!



Disposal:

You can return a PIPRIME® filter cartridge to Nature by simply putting it in a cloth bag and smashing it with a hammer.

Throw all plastic parts into the plastic waste and limescale filter as well as pads into the rubbish.

CARE

- Do not expose the MAUNAWAI® spring to direct sunlight. The darker the **place where it is kept**, the better.
- Filter at least 1–4 litres per day.
- Wash out the **water reservoir** at regular intervals (about once a month) to keep it clean and free from residues.
- It is best to use organic lemon peel to clean the reservoirs (not including the filter modules).
- If the **ceramic filter** discolours or allows too little water to pass through it, it can be washed with water and rubbed with a clean sponge to remove any deposits. **When rubbing the filter, ensure that you apply even, light pressure to avoid excessive abrasion of the ceramic.**
- No special care is required for the **PIPRIME® filter cartridge** other than replacement at regular intervals.
- **If you are away for a short time: If you are unable to use the system for 2 days, ensure that you use it more extensively over the following days. If the water has an unusual taste, empty it out and re-fill the system.**
- If you are **away for up to 3 weeks**, leave drinking water in the lower reservoir so that the PIPRIME® cartridge is under water, and cover the whole system with a cloth. **When you start using it again,**

let the water run out, put the lime scale pad into the water for at least 1 hour and re-fill the whole system with fresh water. If the water has an unusual taste, replace the PIPRIME® filter cartridge.

- In the case of **longer absences** of over 3 weeks, we recommend that you replace the PIPRIME® filter cartridge, rather than continuing to use it.

CHANGING THE FILTERS

We recommend that you **replace the ceramic filter after a year**. At the latest, however, you should replace the ceramic filter when holes appear in its wall that allow water to run through without being filtered.

If you are filtering water of poorer quality than average, the filter capacity may be reduced significantly by frequent removal of sediments.

The **PIPRIME® filter cartridge K2** should be **replaced every 4–6 months** or after 3000 litres of water have been filtered.

We recommend that you **replace the mineral stones after 6 months**.

average life:

PIP RIME® filter cartridge K2: 4–6 months
Ceramic filter: 1 year
Mineral stones: 6 months

Important:

The more contaminated the water, the shorter the lifespan of the filters. If the water contains more contamination than average and the system is used intensively, change the filter every 2–3 months.

Note:

The MAUNAWAI® water cycle:

Once you have tapped some MAUNAWAI® water, you can simply refill the upper tank with tap water.



CAPACITY OF THE COMPONENTS

Plastic filling reservoir: 4 litres
Drinking water reservoir: 8 litres

FILTRATION TIME

The time it takes for the water to be filtered and to flow through the system depends mainly on the ceramic filter.

Water flows through the ceramic filter in about 30 to 120 minutes per litre, depending on the filling level and how it is used.

WARRANTY

Two years for all parts of the system.
The filter modules (PIPRIME® filter cartridge, ceramic filter, limescale filter pad) have a limited warranty period of 30 days.
The warranty will only be honoured with a valid receipt.

LIABILITY

Green d'Or GmbH cannot accept any liability, especially for objects that are not part of the MAUNAWAI® water system.

In the event of improper use or application, all guarantees and warranty claims become null and void.

TROUBLESHOOTING

Description of problem:

The water in the filling reservoir is not flowing into the water reservoir.

Possible cause:

1. Sediments are clogging the ceramic filter.
2. There is still air in the ceramic filter that is slowing down the flow of water.
3. There is still air in the PIPRIME® filter cartridge.

Suggested solutions:

1. Clean the ceramic filter as described in section 5 on page 10.
2. Immerse the ceramic filter in water with the thread uppermost until the air in the filter has escaped.
3. There may also be air in the PIPRIME® filter cartridge. Please remove the filter cartridge and shake it well, then allow tap water to run through it from the bottom once again.
4. Check that there is no mechanical obstruction to the flow.

Description of problem:

Water is running out of the water reservoir.

Possible cause:

1. The seal on the water tap is leaking.
2. The water reservoir is overflowing because its capacity has been exceeded.
3. There is still too much air in the PIPRIME® filter cartridge.

Dimensions:
Width: 30 cm
Height: 55 cm



Suggested solutions:

1. Clean the seals on the water tap and the drinking water reservoir. Ensure that the reservoir is dry when the tap is fitted.
2. Ensure that the capacity (8 litres) of the water reservoir is not exceeded.
3. Remove the filter cartridge and shake it well, then allow tap water to run through it from the bottom once again.

Description of problem:

The water has an unusual smell or taste.

Possible cause:

1. Poor quality water was used, e.g. water containing sulphur or with a high manganese content.
2. The Premium cartridge needs replacing.

Suggested solutions:

1. Filter the same water a second time.
2. Replace the limescale filter pad insert, please soak in water for at least 1h, better overnight, beforehand.
3. Replace the PIPRIME® filter cartridge.

Description of problem:

There is a green coating on the ceramic filter in the top glass reservoir.

Possible cause:

The water contains nitrate and the water system has been placed close to a light source. Nitrate is a plant fertiliser. Depending on the nutrients present and the exposure to light, algae is encouraged to grow

and the nitrate breaks down. This first coating is usually harmless and does not cause any health concerns. However, you should clean the equipment immediately.

Suggested solutions:

1. Do not place the equipment near to a light source and protect it from exposure to sunlight.
2. Clean the equipment. If you are not able to clean it straight away or there is a green coating in the PIPRIME® cartridge, change the filter modules immediately.

Do you have any other questions?
Send us an
e-mail: info@maunawai.com
or give us a call.

CONTACT

Green d'Or GmbH
Adolf-Damaschke-Straße 69-70
14542 Werder (Havel), Germany
e-mail: info@maunawai.com
Website: www.maunawai.com
Service line: +49 3327 570 89 26
Fax: +49 3327 570 89 30

Or contact the sales partner
from whom you purchased
the MAUNAWAI® water filter system.

▶ Our tip:
Try our gluten-free
products!

- Pasta
- Vital substances
- Skin care

www.food-or.de



MAUNAWAI

my Water

MAUNAWAI PIPRIME® water system REPLACEMENT INTERVALS

CERAMIC FILTER

Lifespan:
about 1 year

fitted on:	next replacement:
------------	-------------------

PIPRIME FILTER CARTRIDGE

Lifespan:
about 4–6 months

fitted on:	next replacement:
------------	-------------------

MINERAL STONES

Lifespan:
about 6 months

fitted on:	next replacement:
------------	-------------------

© 2015 Green d'Or GmbH · MAUNAWAI and the MAUNAWAI logo are registered trademarks.